

SOILRIPPER[™] Tillage Points



**NEW!
LONG-LASTING
STEEL FORMULA**

Ingersoll's new SoilRipper tillage points feature a robust design and superior carbidic austempered ductile iron to withstand the most challenging soil conditions, providing the best overall value choice. Brought to you by the company you can trust for leading quality.

Features

- Patent protected design
- More robust design with extra high strength steel for longer service life
- Wing and nose surface geometry generates maximum soil fracturing while reducing draft loads
- As they wear, SoilRipper points maintain their ability to penetrate the toughest soil conditions
- Wear feature protects mounting hardware
- Ideal for high speed compaction-busting tillage applications

SOILRIPPER™ Tillage Points

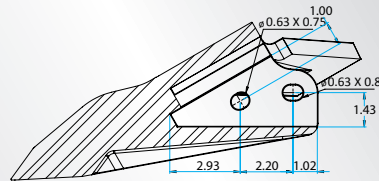
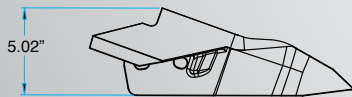
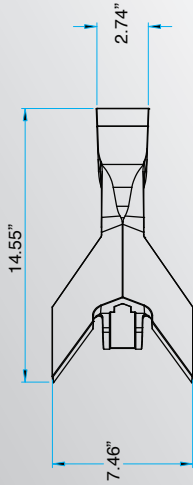

Specifications

- Solid one-piece cast for extreme durability with super hard steel
- Formed from CADI (Carbide Austempered Ductile Iron)
- CADI offers 30% longer life over previous material
- Rockwell hardness score of 47.7 Rockwell C (456 Brinell)
- Weight: 9670 g (9.7 kg, 21.3 lbs.)
- 7.5" winged SoilRipper point designed for a 1.25" shank width
- Designed to fit Case-IH, DMI, Krause and John Deere equipment
- Additional designs, models and sizes to come



ISO 9001:2008 Certified
(888) 768-1740 www.IngersollTillage.com